



MUSEUM | TRADE SHOW | CORPORATE | RESIDENTIAL | RETAIL

1174 Comstock Street, Suite B, Marne, MI 49435
www.spacestoexperiences.com

ABOUT SPACES TO EXPERIENCES

Jerry Knapp founded Spaces to Experiences as a fabrication company in 2005. Very soon after that we began partnering with various designers to broaden our range of capabilities. Since then we have completed projects nationwide. Our talented staff of craftsmen have a combined 75 years of experience in design engineering and fabrication of high-quality exhibits and other components. We serve clients that include museums, visitor centers, store planners, architects and designers, integrated marketers, sign companies, fixture manufactures, the furniture industry, and government agencies on the city, county, state and federal level.

Our highly skilled in-house talent base has the experience and ability necessary to help bring vision to reality in an efficient and effective manner. We are always mastering new materials and technologies, allowing us to provide the latest state of the art, visually stimulating displays and exhibits. By maintaining our high-quality standard, we have won the loyalty of the most demanding customers in the industry. It is this standard that has made our company successful for more than 10 years. Our 6,000-square foot facility is conveniently located just off I-96 in Marne, Michigan. This location affords the luxury of lower overhead while maintaining close proximity to our vendor network in Grand Rapids and Muskegon.

OUR CAPABILITIES

With effective Project management and strong communication skills, we provide the following services with creativity, ingenuity, flexibility, and practicality:

EXHIBIT DESIGN: Exhibit design projects begin with programming and curatorial conception and proceeds through schematic design into detailed fabrication drawings. We utilize CAD programs and can create animated interior renderings to use to review design concepts and in fund raising efforts. Our professional background allows us to coordinate effectively and efficiently with our clients' architectural professionals. We can also provide interior design and lighting specification to assure that the finished shell suits the concept of the exhibits.

GRAPHIC DESIGN AND ILLUSTRATION: From large scale banners to exacting text, our team prepares compelling graphic elements using a broad range of materials and processes. Easy to read, engaging, and durable graphics are our hallmark.



MULTI-MEDIA PRODUCTION: We have the talent and a connected network to develop interactive audio and video experiences, large screen video walls, ambient audio programming, and individual interactive elements.

FABRICATION AND INSTALLATION: Our skilled team of crafts people combine years of fabrication experience with cutting edge manufacturing technologies to create beautifully finished, durable exhibits of the highest quality. Through value engineering, we find creative ways to contain costs. The same team who builds the exhibits installs the exhibits. The project culminates in a review, completion of a punch list, and delivery of maintenance manuals and user instructions.

APPROACH TO OUR PROJECTS

PHILOSOPHY: Exhibits must be visually appealing, attract attention, draw visitors in, and inspire them. The ever-shortening attention spans of the vastly diverse audience requires exhibits to engage deeply with the content message. We consider visitors our partners: They must be made to feel that the facility was made for them and prompts them to deeply explore and engage in the exhibits.

TECHNICAL APPROACH: Our approach is creative and practical. Our design will incorporate components made from readily available materials and hardware for ease of ongoing maintenance and repairs. We understand that our clients are making an investment and as such we design elements for continued use for many years to come. We believe that a successful design is the result of a collaborative effort between the client and design team. We listen to our clients and respect the knowledge and experience they bring to the table.

COST ANALYSIS AND CONTROL: By having in-house ability to design and produce, we can supply reliable cost analyses throughout the design phase to ensure our projects are produced within budget and on time. Before each submittal, our team reviews the design and content documents and updates the budget estimate. We value engineer designs to consider alternative ways to accomplish the same objective or to prioritize exhibit elements and budget. For specialties outside of our capabilities, we maintain an established network of tight vendor relationships.





As Operations Manager, Jerry oversees all projects that come through our door. He will be there to answer any questions or resolve any issues that arise throughout the entire process. His capabilities include display and interactive engineering, electronic component assembly and modification, welding and carpentry. With his extensive experience and knowledge of facilities, exhibits, design engineering, and budgeting, he will assure that the design is meeting the intended outcome as it relates to expectations and budget.

EXPERIENCE

Owner/Operations Manager | **Spaces to Experiences** | Sept. 2015 – Present
Full-service exhibit firm

Founder | **Exhibit Resources, LLC.** | Jan. 2006 – Sept. 2015
Full-service exhibit firm. Purchased by and merged into Spaces by Witvoet in 2011.

Exhibit Installation Manager | **INvironments** | Oct. 2002 – Jan. 2006
Oversaw all exhibit installations on-site.

Installation Manager | **Xibitz** | Sept. 1998 – Oct. 2002
Exhibit fabrication, installation, and installation management.

Project Manager | **Creative Visions** | Oct. 1992 – Sept. 1998
Project management on residential construction projects.

Project Manager/Lead Carpenter | **Oom Builders** | Sept. 1990 – Oct. 1992
Residential framing, trim, and remodeling.

Carpenter | **LDC, Inc.** | July 1989 – Sept. 1990
Commercial framing, trim, and cabinetry.

Carpenter | **Self-Employed** | Aug. 1986 – July 1989
Framing and trim in residential and light commercial settings.

Carpenter | **Fase Home Builders** | June 1985 – Aug. 1998
Framing, trim, and miscellaneous repair.

Carpet Installer | **Andrew Knapp** | June 1983 – June 1985

EDUCATION

Creston High School | 1985
Kent Skills Center Residential Construction Program
State Builders License | August 1988

Mindy Conley

Project Manager and Lead Designer

Mindy has been involved in every aspect of design, fabrication, and installation of museum exhibits. She has supervised or directly designed and installed over 200 exhibits ranging in size from single display cases to full galleries, with expected life spans of a few months to many years. Her capabilities include conceptual design, final design, 2D illustrations, virtual 3D models, text editing, graphic design, and project management. She has 17+ years of museum exhibit experience and has designed the interiors of non-exhibit spaces like offices, meeting rooms, and lobby areas. Mindy also has extensive artifact handling and mount-making experience and is knowledgeable about artifact care.



EXPERIENCE

Project Manager/Lead Designer | **Spaces to Experiences** | 2017-Present

Create graphic designs, 3D exhibit designs, and illustrations as needed for projects and proposals. Build and render exhibit models in SketchUp; output construction drawings of components. Manage supply orders, estimates & invoicing; develop inner-office forms and tracking systems.

Freelance Designer | 2014-2017

Created graphic layouts for project proposals, corporate lobby walls, corporate history timeline, project illustrations, and website design.

Curator, (later Director of Exhibits & Collections) | **Lakeshore Museum Center** | 2002- 2014

Designed and facilitated updates to temporary and permanent exhibits. Managed short- and long-term schedules and budgets. Supervised staff of exhibit and collections departments, oversaw exhibit and collections management programs.

Director of Exhibits (prior intern) | **Nat'l New York Central Railroad Museum** | 2000 - 2001

Research, writing, and development of new exhibit projects as budgets allowed. Maintained current exhibits. Researched and collected data regarding museum's artifact collection.

EDUCATION

Bachelor of Fine Art | University of Michigan | 2001

Majored in Industrial Design & Ceramics

Magna Cum Laude

Attended Baker College Online | Spring 2016 - Fall 2017

Worked toward Bachelor of Science in Web Development

ADA HISTORICAL SOCIETY, 2020
Ada is...Rooted in Trade

Design & Fabrication: Spaces to Experiences

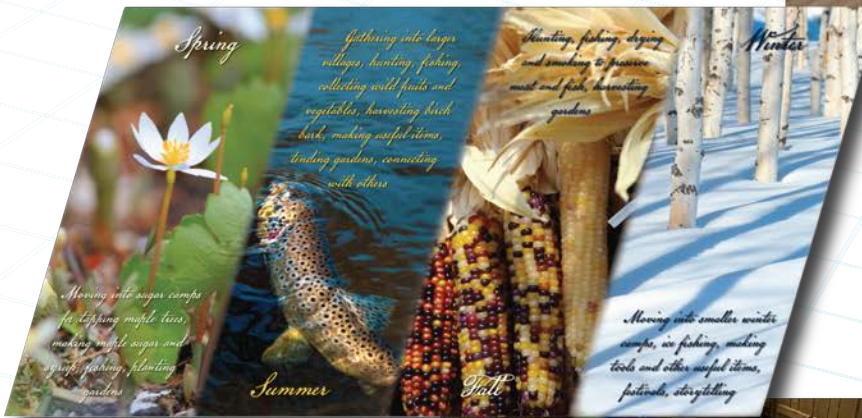

KRASL ART CENTER, 2018

Outdoor Signage

Design & Fabrication: Spaces to Experiences



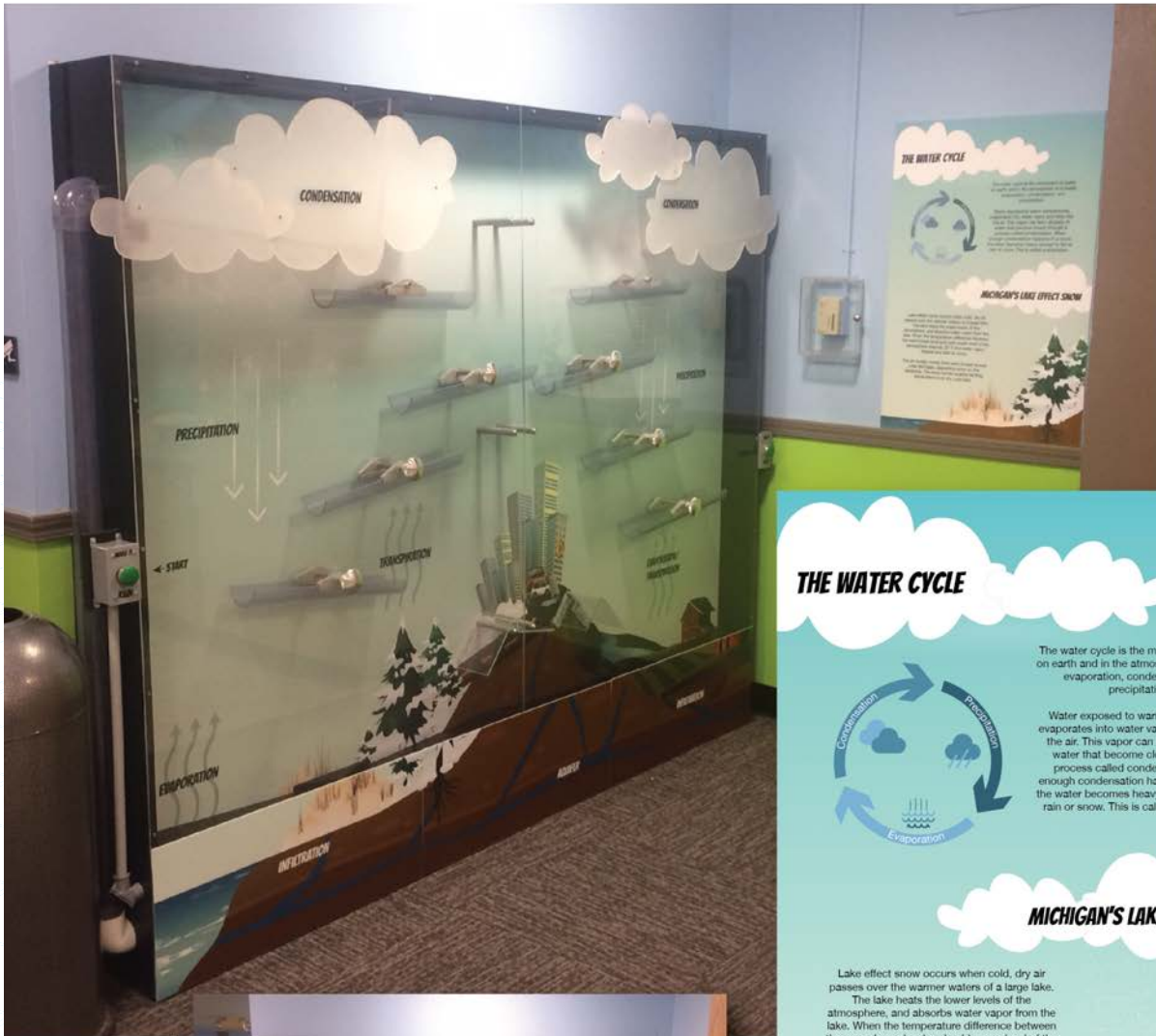

LEGACY OF THE PLAINS, 2014-2016

All Galleries, New Building

Designer: Root House Studio

Fabrication: Spaces to Experiences

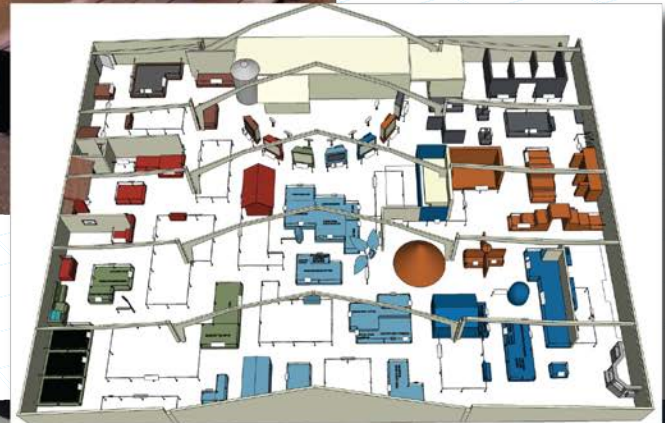

LENAWEE COUNTY MUSEUM, 2018
Anti-Slavery and the Underground Railroad in Lenawee County
Design and Fabrication: Spaces to Experiences

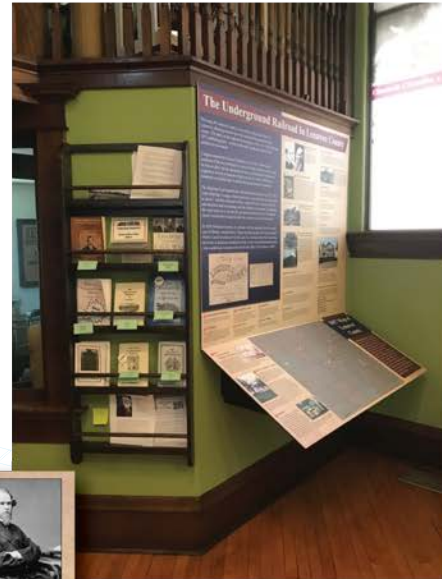

MASON COUNTY SPORTS HALL OF FAME, 2020

Beyond the Game: The Value of Sports

Design: Spaces to Experiences with Lafferty van Heest and Associates

Fabrication: Spaces to Experiences



MICHIGAN MARITIME MUSEUM, 2022
Full Steam Ahead

Exhibit Design & Fabrication: Spaces to Experiences
Graphic Design: Lafferty van Heest and Associates



PUMP HOUSE MUSEUM AND LEARNING CENTER, 2019

Big Red

Designer: Lafferty van Heest and Associates

Fabrication: Spaces to Experiences

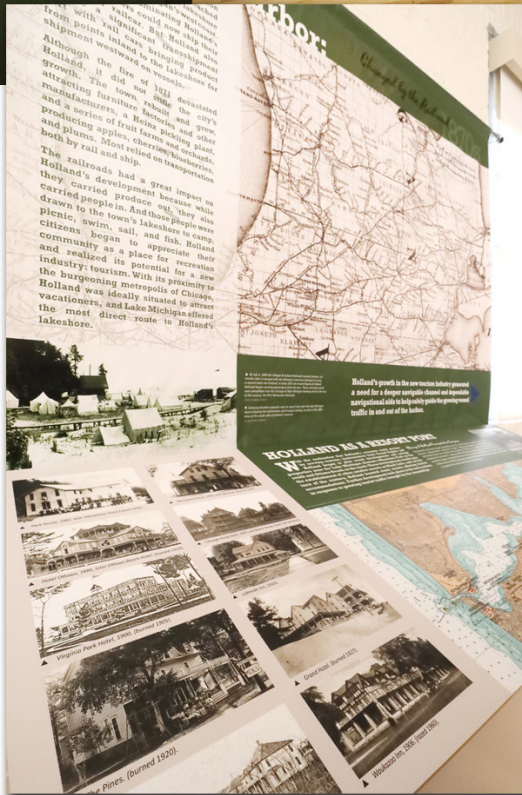

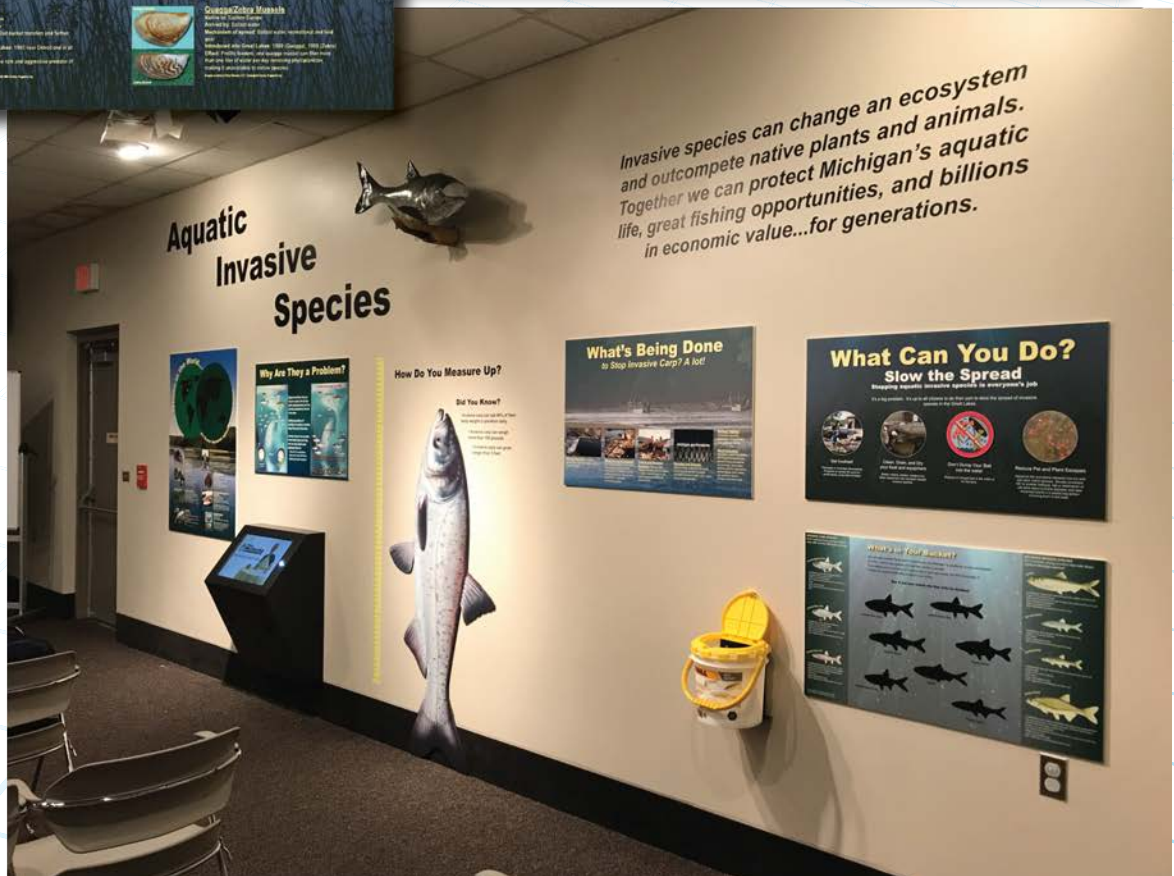

PARTIAL CLIENT LIST

Army Corp of Engineers
Chicago Maritime Museum
Coconino National Forest Visitor Center
Lake St. Clair Metropark
Mason County Historical Society
National Park Service, Hoover Dam
Park Township Plaza
Port of Ludington Maritime Museum
United States Forest Service/USAID
AGC Automotive Americas
City of Southfield

GHSP Industries
Gill Industries
Soundoff Signal
TGW Logistics Group GmbH
Cascade Historical Society
Engine House No. 5
Gillette Sand Dunes Visitor Center
Grand Rapids Public Museum
Brookside Cemetery
Ludington State Park
MI Department of Natural Resources

Visit our website to see more of our work!
www.spacestoexperiences.com



